



### User manual v1.3

#### CONTENTS OF PACK

Item	Quantity
1. EWK2/EWK2A.....	1
2. CR2032 3V lithium battery.....	1
3. User manual.....	1
4. Keychain.....	1

#### Main features:

- Alarm system arming & disarming;
- PGM output control;
- Partition switch;
- Stay Arm;
- Visual and audio indication of command status.

#### 1. GENERAL INFORMATION

EWK2/EWK2A is a wireless device intended to remotely arm and disarm ELDES alarm system, cause system alarm (EWK2A Panic Alarm) or to control any electric appliance connected to the alarm system's PGM output (EWK2). The maximum wireless connection range is 150m (492.13ft) (in open areas). By default, one pair of EWK2 buttons is already configured to arm and disarm the alarm system (configurable). ELDES alarm system supports up to 16 EWK2/EWK2A devices with the same configuration (Public configuration) or up to 5 EWK2/EWK2A devices with custom configuration (Private configuration).

#### 2. TECHNICAL SPECIFICATIONS

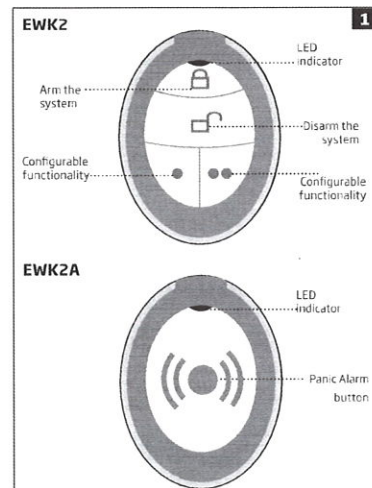

**NOTE:** Pic. No.1 reflects the default EWK2/EWK2A button configuration. All keyfob buttons are configurable according to individual needs via *Eldes Utility* software.

#### 2.1. Electrical & Mechanical Characteristics

Battery type.....	3V Lithium CR2032 type 5004LC (ANSI/NEDA)
Quantity of batteries.....	1
Battery operation time.....	~18 months*
Wireless band.....	ISM868/ISM915
Range of operating.....	-10...+55 °C (14...+131°F) temperatures
Humidity.....	0-90% RH @ 0...+40°C (0-90% RH @ +32...+104°F) (non-condensing)
Dimensions.....	53x37x12mm (2.09x1.46x0.47in)
Wireless.....	Up to 150m (492.13ft) in open areas
Compatible with.....	PITBULL ALARM PRO and ESIM384 (all FW versions)

\* This operation time can be achieved by pressing the keyfob button up to 4 times per day. The operation time depends on different conditions and may vary.

#### 3. HOW TO USE:

- In order to start using wireless keyfob EWK2/EWK2A, it has to be paired with ELDES alarm system using *ELDES Utility* software.

- EWK2 keyfob features 4 configurable buttons intended to operate according to individual needs, while EWK2A keyfob model features one configurable button.

- After the button is pressed, EWK2/EWK2A internal buzzer's **1 short beep** sound (EWK2A buzzer sound disabled by default) and a single red LED indicator flash confirms a transferred command to ELDES alarm system via wireless connection. Otherwise, **1 long beep** sound and a single red LED indicator flash will inform about unsuccessful attempt to transfer command (presuming that there is no wireless connection to the alarm system).

- The status of the sent command can be checked by attempting to receive the feedback signal from the alarm system (valid **only for Arm/Disarm** commands). This can be performed by **pressing and holding down** the same button for a couple of seconds, **until the keyfob sounds**:

**A)** 3 short beep sounds and LED indicator flashes indicate a successfully carried out Arm/Disarm command;

**B)** 1 long beep sound and a single LED indicator flash stands for failed Arm/Disarm command and feedback signal failure;

- EWK2A Panic Alarm feature: if you press EWK2A button while there is no wireless connection, the keyfob will try to send a data event to alarm system every 10 seconds. In case there is no response after 30 minutes of attempts, the EWK2A keyfob will completely ignore the event.

- EWK2A has an advanced setting, which allows to enable button reaction delay time (to prevent unintentional button pressing). The reaction delay time is disabled by default, thus it can be enabled using *ELDES Utility* software. If this feature is enabled, user must enter the preferred reaction delay time value in order to be able to save settings.

- EWK2A has one more feature, which allows to enable keyfob's Buzzer. If this feature is enabled, buzzer will beep once every time EWK2A button is pressed (by default, the feature is disabled). In case when Panic Alarm feature is enabled, **it is recommended to disable** keyfob's Buzzer due to security reasons.

#### 4. INSTALLATION

- Remove the screw located on the back side of EWK2/EWK2A enclosure (see pic. 2).

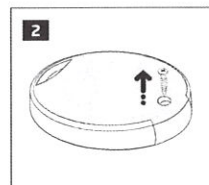

- Open the enclosure (see pic. 3).

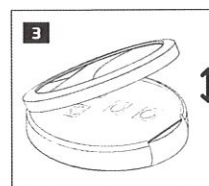

- Once the enclosure is opened, remove the PCB from the EWK2/EWK2A enclosure and flip the PCB so that the back side would be facing up (see pic. 4).

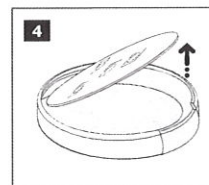

- Insert the CR2032 type battery provided in the EWK2/EWK2A package. Before inserting the battery, ensure that it is positioned correctly (see pic. 5).

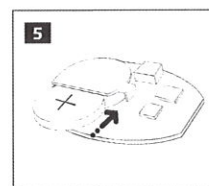

- Insert the PCB back to the enclosure and close it (see pics. 6 and 7).

