

DHI-LCH55/65/75/86-MC410-B

55/65/75/86 inch Smart Interactive Whiteboard



System Overview

Dahua DeepHub Lite Series Smart Interactive Whiteboard has powerful processing capabilities with its built-in 4-core CPU, 4-core GPU, 4G RAM, 32G storage, and Android 9 OS. With a high-precision infrared touch sensor and a 4K DLED display, Dahua DeepHub will give you an extraordinary experience of writing, controlling, and content displaying. It features video conferencing, wireless screen sharing, UHD display, scan & go, etc., and will be your go-to choice to digitalize your office and classrooms.

Functions

Real Writing Experience

The intelligent whiteboard supports pen-point writing. With its Zero Air-Gap technology and low latency, writing on the whiteboard feels natural, similar to the real writing experience.

Wireless Screen Sharing

In addition to basic file sharing, the device offers wireless screen sharing, interactive operations between two screens, and reverse transmissions. It also supports screen grouping (multiple transmission), host mode (for overall permission control), real-time transmission of images, videos and audios from the wireless camera of the mobile phone to the device, and split-screen mode that displays up to 9 splits on the same screen.

Easy to Share

Enhances the experience of sharing files by scanning a code. It automatically determines the network of the device to readily share the QR code across the extranet and the intranet. QR code encryption and extraction are also featured, providing privacy and data security through the required entry of a 6-digit password for verification.

Hidden Antenna Design

The Wi-Fi and hotspot antenna is neatly concealed in the front of the device, ensuring the stability of the signal strength when using a flush mount, and giving the device its simple and sleek appearance.

- 4K HD display.
- Supports using both Android and Windows (PC module must be installed).
- Wireless screen sharing from multiple devices, such as phones, computers, and tablets.
- Supports being written on with a stylus.
- Supports Office software, and playing videos and audio files.
- The startup channels are all customizable.
- Wired and wireless network support.
- Built-in 5-MP camera.

Scene

The whiteboard is ideal for use in indoor sites such as in meeting rooms, command centers, hospitals, banks and classrooms.

Technical Specification

Built-in System

Operating System of External Module	Android 9.0
CPU	Quad-core A55
CPU Frequency	1.9 GHz
GPU	Mali-G31 MP2
RAM	4 GB
ROM	32 GB

Function

Applicable Operating Systems	Windows 7/8/10; Android
WiFi	Dual-band 2.4 GHz/5 GHz
Wi-Fi Hotspot	Dual-band 2.4 GHz/5 GHz; supports enabling hotspot and Wi-Fi at the same time

LCD Panel

Panel Dimensions	55-inch; 65-inch; 75-inch; 86-inch
Backlight	DLED
Aspect Ratio	16:9
Brightness	55-inch: 300 cd/m ² ; 65-inch: 350 cd/m ² ; 75-inch: 350 cd/m ² ; 86-inch: 400 cd/m ²
Resolution	3840 (H) × 2160 (V) UI: 1920 (H) × 1080 (V)
Viewing Angle	H: 178°; V: 178°
Lifespan	50,000 hours
Display Color	1.07 B/10 bit (8 bit + FRC)

Response Time	8 ms (typ.)
Refresh Rate	60 Hz
Static Contrast	VA: 4000 (typ.); IPS: 1200 (typ.)

Camera

Pixel	5 MP
Auto Control	Auto white balance
Distortion	≤ 5%
Max. Resolution	Android: 1080p@30fps; OPS: 2560 × 1440@30fps
Field of View	H:84.5°; V: 54.0°; D: 93.1°

Device Ports

Light Sensor	1
Front Button	1 × Power button (right side)
Front Ports	1 × USB 3.0 (left side)
Network Port	1 × RJ-45
Wi-Fi	1 × Wi-Fi; 1 × hotspot
USB	2 × USB 3.0 (Rear-facing); 1 × Micro-USB
RS-232	1 × RS-232
Video Input	1 × HDMI IN
Audio Output	1 × 3.5 mm (Line out)
Others	1 × Touch
IrDA	1
Microphone	2

Touchscreen

Touch Technology Type	IR touch technology
Response Time	< 10 ms
Touch Points	20
Valid Touch	2 mm
Writing Mode	Finger + Stylus pen
Communication Mode	USB
Anti-light Interference	Anti-glare tempered glass
Surface Hardness	8H
Touch Resolution	32767 × 32767
Number of Multi-user Writing Points	2

Speaker

Power	Full frequency: 2 × 15 W
Built-in Speaker	2

Microphone

Pick-up Distance	Far-field sound pickup: 6 m–8 m (19.69 ft–26.25 ft)
------------------	---

Number of Microphones	2
AGC	Yes
Echo Cancellation	Yes
Polar Pattern	Omnidirectional
Intelligent Noise Filtering	YES

General

Power Supply	100–240 VAC, 50 Hz/60 Hz
Power Consumption	55-inch: 90 W (typ.); 200 W (max.); 65-inch: 90 W (typ.); 250 W (max.); 75-inch: 110 W (typ.); 300 W (max.); 86-inch: 120 W (typ.); 400 W (max.)
Operating Temperature	0 °C to +40 °C (32 °F to +104 °F)
Storage Temperature	–10 °C to +50 °C (–14 °F to +122 °F)
Operating Humidity	10%–90% (RH)
Storage Humidity	10%–90% (RH)
Product Material	Metal casing
Casing Color (Frame/Rear)	Bottom: Silver; top/left/right: black
Product Dimensions	65-inch: 1,485.0 mm × 86.9 mm × 924.7 mm (58.46" × 3.42" × 36.41") (L × W × H) 75-inch: 1,707.2 mm × 87.1 mm × 1,050.1 mm (67.21" × 3.43" × 41.34") 86-inch: 1,953.0 mm × 87.1 mm × 1,188.6 mm (76.90" × 3.43" × 46.80") 55-inch: (with camera): 1,261.4 mm × 80.9 mm × 816.6 mm (49.66" × 3.19" × 32.15") (L × W × H) 65-inch: (with camera): 1,485.0 mm × 86.9 mm × 941.2 mm (58.46" × 3.42" × 37.06") 75-inch: (with camera): 1,707.2 mm × 87.1 mm × 1,066.4 mm (67.21" × 3.43" × 41.98") 86-inch: (with camera): 1,953.4 mm × 87.1 mm × 1,205.1 mm (76.91" × 3.43" × 47.45")
Frame Size	Top: 43.1 mm (1.70"); left/right: 16.1 mm (0.63"); bottom: 67.8 mm (2.67")
Packaging Dimensions	55-inch: 1,366 mm × 180 mm × 935 mm (53.78" × 7.09" × 36.79") (L × W × H) 65-inch: 1587 mm × 235 mm × 1070 mm (62.48" × 9.25" × 42.13") 75-inch: 1610 mm × 235 mm × 1157 mm (71.26" × 9.25" × 45.55") 86-inch: 2056 mm × 235 mm × 1334 mm (80.94" × 9.25" × 52.52")
Net Weight	55-inch: 27.5 kg (60.63 lb) 65-inch: 38 kg (83.80 lb) 75-inch: 54 kg (119.10 lb) 86-inch: 64 kg (141.10 lb)
Gross Weight	55-inch version: 32.5 kg (71.65 lb) 65-inch version: 46 kg (101.41 lb) 75-inch version: 65 kg (143.30 lb) 86-inch version: 77 kg (169.76 lb)
Holes Distance	55-inch version: 400 mm × 400 mm (15.75" × 15.75") 65-inch version: 400 mm × 500 mm (15.75" × 19.69") 75-inch version: 400 mm × 600 mm (15.75" × 23.62") 86-inch version: 400 mm × 750 mm (15.75" × 29.53")
Installation	Wall mount, mobile bracket

Standby Power Consumption	0.5 W
Packing List	Smart interactive whiteboard 1; Power cord 3; Stylus pen 2; Quick start guide 1; Wall mount bracket (already installed on the whiteboard) 1; Accessory package 1
Certifications	CE

Installation

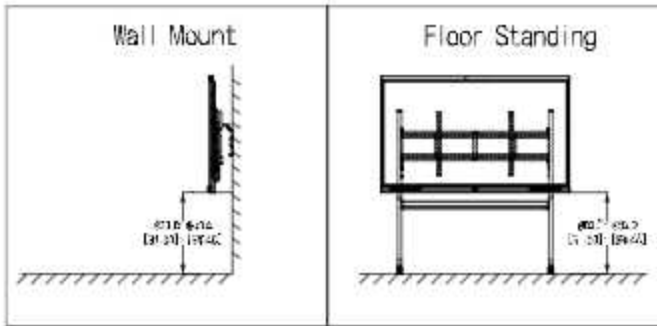

Dimensions (mm[inch])

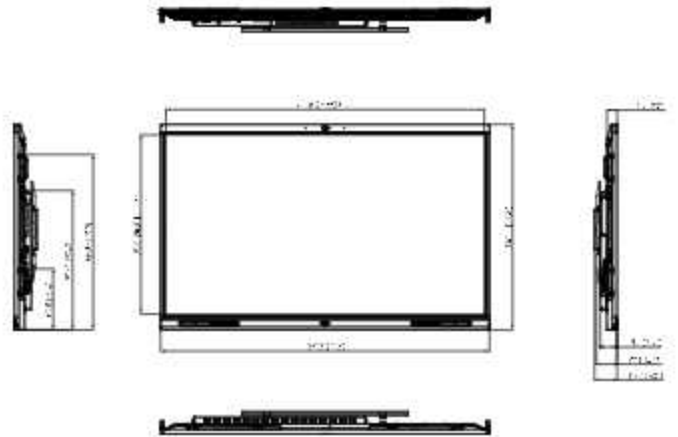
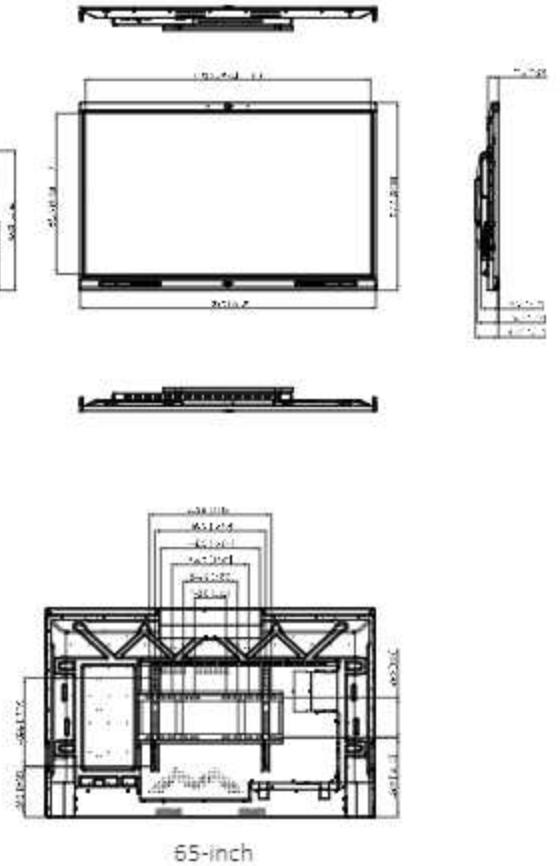
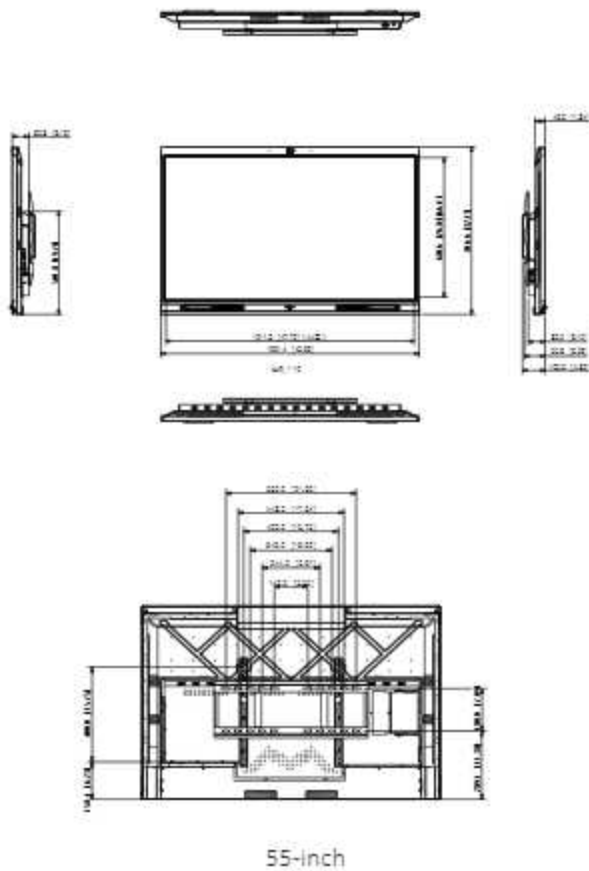

Panels

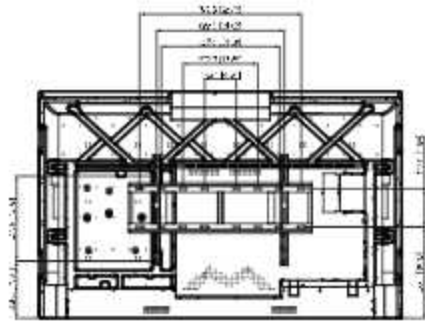

75-inch

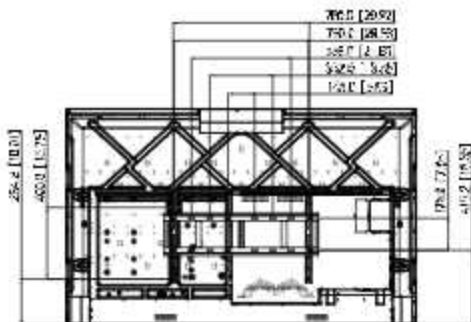

86-inch

48.5" [1231.5]

35.24" [896.5]

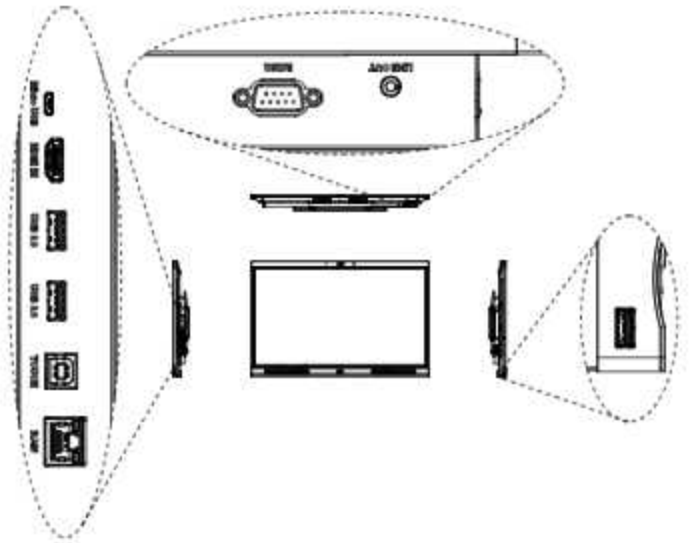

55-inch

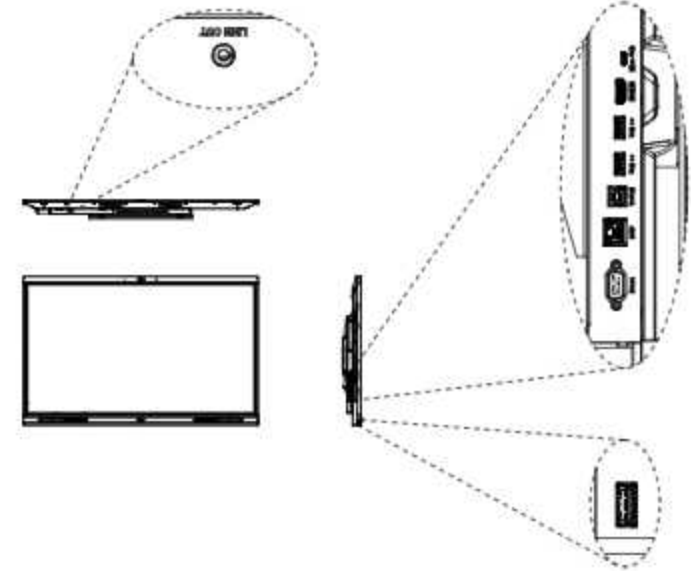

65/75/86-inch